

WELL SCHEDULE

U. S. DEPT. OF THE INTERIOR

GEOLOGICAL SURVEY

WATER RESOURCES DIVISION

MASTER CARD #

Record by FWR Reed Source of data from county file Date 6-23-39 Map _____

State 28 County (or town) Pearl River 55

Latitude: 303939N Longitude: 08938 Sequential number: 1

Lat-long accuracy: 4 T 4 S 16 E 31 Sec 31, NW & NE

Local well number: Q 0 2 3 B A 3 1 0 4 S 1 6 W Other number: _____

Local use: _____ Owner or name: Miss Experimental Station

Owner or name: MISS EXP STA Address: _____

Ownership: County, Fed Gov't, City, Corp or Co, Private, State Agency, Water Dist S

Use of water: (A) Air cond, Bottling, Comm, Dewater, Power, Fire, Dom, Irr, Med, Ind, P S, Rec, (S) Stock, Inscit, Unused, Repressure, Recharge, Desal-P S, Desal-other, Other H

Use of well: (A) Anode, Drain, Seismic, Heat Res, Obs, Oil-gas, Recharge, Test, Unused, Withdraw, Waste, Destroyed, (D) _____, (G) _____, (H) _____, (Ø) _____, (P) _____, (R) _____, (T) _____, (U) _____, (W) _____, (X) _____, (Z) _____ W

DATA AVAILABLE: Well data Freq. W/L meas: Field aquifer char.

Hyd. lab. data: _____

Qual. water data; type: _____

Freq. sampling: _____ Pumpage inventory: yes, no, period: _____

perature cards: _____

Log data: _____

WELL-DESCRIPTION CARD

SAME AS ON MASTER CARD Depth well: 200 Meas. 6

Depth cased: _____ ft _____ Casing type: _____; Diam. _____ in 4

Finish: (C) porous concrete, (F) gravel w. concrete, (G) gravel w. (screen), (H) horiz. gallery, (Ø) open end, (P) perf., (S) screen, (T) sd. pt., (W) shored, (X) open hole, (Z) other H

Method: (A) air rot, (B) bored, (C) cable, (D) dug, (H) hyd rot., (J) jetted, (P) air percussion, (R) reverse, (T) trenching, (V) driven, (W) drive wash, (Z) other H

Date Drilled: 9-2-8 Pump intake setting: _____ ft _____

Driller: _____ name _____ address _____

Lift (type): (A) air, (B) bucket, (C) cent, (J) jet, (M) multiple, (N) none, (P) piston, (R) rot, (S) submerg, (T) turb, (Z) other Deep

Power (type): (nat) diesel, elec, gas, (LP) gasoline, hand, gas, wind; H.P. 3 1/2 Trans. or meter no. F

Descrip. MP _____ ft above _____ ft below LSD, Alt. MP _____

Alt. LSD: _____ Accuracy: (source) _____

Water Level _____ ft above _____ ft below MP; _____ ft below LSD 85 Accuracy: _____

Date meas: _____ Yield: _____ gpm _____ Method determined _____

Drawdown: _____ ft _____ Accuracy: _____ Pumping period _____ hrs _____

QUALITY OF WATER DATA: Iron _____ ppm Sulfate _____ ppm Chloride _____ ppm Hard. _____ ppm

Sp. Conduct _____ K x 10 _____ Temp. _____ °F _____ Date sampled _____

Taste, color, etc. _____

Well No. Q 23

Latitude-longitude _____
N
S
d m s d m s

HYDROGEOLOGIC CARD

SAME AS ON MASTER CARD Physiographic Province: 03 Section: _____

D Drainage Basin: 13V Subbasin: _____

Topo of well site: (D) depression, stream channel, dunes, flat, (H) hilltop, sink, swamp, (K) (L) offshore, pediment, hillside, terrace, undulating, valley flat. (P) (S) (T) (U) (V) _____

MAJOR AQUIFER: _____ system series TM aquifer, formation, group MZ

Lithology: _____ Origin: _____ Aquifer Thickness: _____ ft

Length of well open to: _____ ft Depth to top of: _____ ft

MINOR AQUIFER: _____ system series _____ aquifer, formation, group _____

Lithology: _____ Origin: _____ Aquifer Thickness: _____ ft

Length of well open to: _____ ft Depth to top of: _____ ft

Intervals Screened: _____

Depth to consolidated rock: _____ ft Source of data: _____

Depth to basement: _____ ft Source of data: _____

Surficial material: _____ Infiltration characteristics: _____

Coefficient Trans: _____ gpd/ft Coefficient Storage: _____

Coefficient Perm: _____ gpd/ft²; Spec cap: _____ gpm/ft; Number of geologic cards: _____

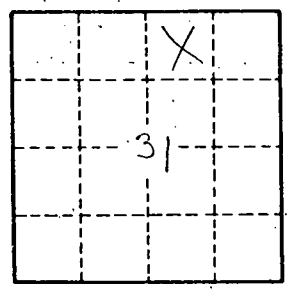
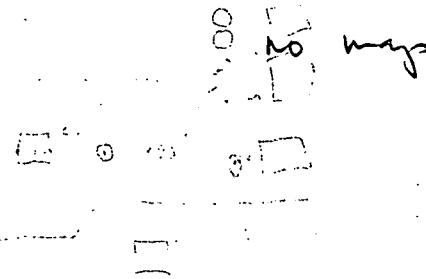

Well No. _____